

Christ Church Worthing



The Parish of Holy Trinity with Christ Church

Grafton Road, Worthing, West Sussex BN11 1QY

*All that the Father gives me will come to me, whoever comes
to me I will never drive away*

John 6: 37

PARISH PROFILE 2017

Welcome

Welcome to our Parish Profile. We hope you enjoy reading it!

In the following pages, we have tried to give a flavour of who we are, where we are and what we believe God may have in store for us. You will find here something of the church's capabilities and aspirations. It also outlines the qualities of the person we believe we need to inspire us to achieve our mission, unite us in our purpose and facilitate our participation in God's work in Worthing.

Amongst our challenges are to continue our established mission of working with the old and/or lonely living in the town centre, welcoming the many visitors from our town, or from across the world. Some are here to study for a short while, or are working here, away from family and friends. We welcome the lonely, the mentally sick, the 'forgotten souls' of the town, and have 'open doors' for all. Our aim is to serve as a spiritual focus for the whole town centre community, both residents and those who work in the parish, and to develop, successfully, inclusive services of worship that offer something for everyone - for those who have no knowledge of church and those who favour the more traditional type of worship. To take the church forward we have a visionary 10 year plan of reordering, to accommodate all.

We are a church community that rejoices in the diversity of Christian belief and understanding within our church family so that we can witness with authority and integrity to the love of Jesus Christ in the world. We believe in God made known to us in the humanity of Jesus of Nazareth, so that we actively seek His face in those around us.

We believe in God who animates, energises and inspires us, so that we develop our faith by enquiry and wonder about the world, living and working within the community. Standing firmly in the historic breadth of Christianity in the Anglican Church, yet rooted humbly in the awareness of our own boundaries and limitations, we strive to welcome all, to include all.

Above all, we seek someone who can accompany us on this journey of faith.

If you believe that might be you, please read on, we should be delighted to hear from you.

The Parochial Church Council of the Central Worthing Parish of Holy Trinity with Christ Church

The Town of Worthing



Worthing is a large seaside town with borough status in West Sussex, within the historic County of Sussex, forming part of the Brighton, Worthing, Littlehampton conurbation. It is situated at the foot of the South Downs, 10 miles (16 km) west of Brighton, and 18 miles (29 km) east of the county town of Chichester. The

borough covers an area of 12.5 square miles (32.37 km²) and has an estimated population of 105,000.

Modern Worthing has a large service industry, particularly in financial services. It has a large hospital, indoor swimming pool, bowling alley, three theatres and one of Britain's oldest cinemas all in or near the town centre. Writers Oscar Wilde and Harold Pinter lived and worked in the town.



Worthing's main civic centres, the Town Hall, Assembly Hall, Library and Magistrate's Court, all fall within the Parish boundary.

Mission Statement

As a Parish, we aspire to be a church for everyone. Offering hospitality to all, whatever their faith and circumstances, is what we do best; we want to continue to serve all people in the name of God, commending by prayer, word and action the good news of the transforming love of God through Jesus Christ in the power of the Holy Spirit.

The Parish

The Parish lies in the heart of the town, within yards of all civic buildings. In 2011, there were 4,800 residents, the largest proportion of which are 16 – 64 [67%]. Within the population in the parish 60% live alone, and the majority are in private rented accommodation. Within a mile of Christ Church, there are six Church of England churches, and three of other Christian denominations. Our present congregation is made up of active and not so active elderly, with some younger retired folk, most with time and skills that are put to good use. We recognise that there will always be a need for a traditional 'middle of the road' style church, which we are, catering for the needs of the newly retired and elderly, and yet also with aspirations to be able to offer more for the younger age ranges, especially when we have created space for them, as detailed in our plans for reordering. There are several home groups that meet locally in the parish. We have offers of new venues within some parishioners' homes, and so we look forward to increasing our existing groups.

Worship

1st, 3rd and 5th weeks: Holy Communion at 10.30 am [Common Worship]

2nd & 4th weeks: Morning Prayer at 10.30 [Common Worship]

1st and 3rd weeks: BCP Evensong at 6pm

2nd and 4th Thursdays: 12.30 pm BCP shortened BCP Holy Communion - ***recently changed from 10.30 am to accommodate the members of a local Building Society who expressed the desire to attend in their lunch break***

Parishioners routinely lead the intercessions at all services

Church Buildings

Christ Church and its closed burial ground sits in the heart of the town, between Grafton Road and Portland Road, and has the distinction of being the first church in Worthing built in the gothic revival style. Christ Church was built by subscription between 1840 and 1843. It is Worthing's most conspicuous flint building and still retains the original

cobbled flint wall surrounding the church yard. The present organ was installed in 1970, made in 1892 by J.J. Binns of Leeds, and was purchased from a Methodist Church in Rochdale, an excellent three-manual instrument.

Christ Church has begun a fully costed 10 year plan of reordering. We have already installed a suite of modern toilets, with disabled and baby changing facilities, with wheelchair access and self-opening doors to the North side. There is also a fully fitted, commercial modern kitchen used for church events and groups.

In 2014, the PCC obtained a faculty to remove some pews from the centre of the back of the church at the west end, creating a much-needed space for community activities, welcoming visitors and parishioners, serving coffee and tea, as well as a knit and natter club and fund raising activities and is consistently 'manned' by our parishioners two mornings and one afternoon a week, as well as Saturday mornings and every Sunday after services.

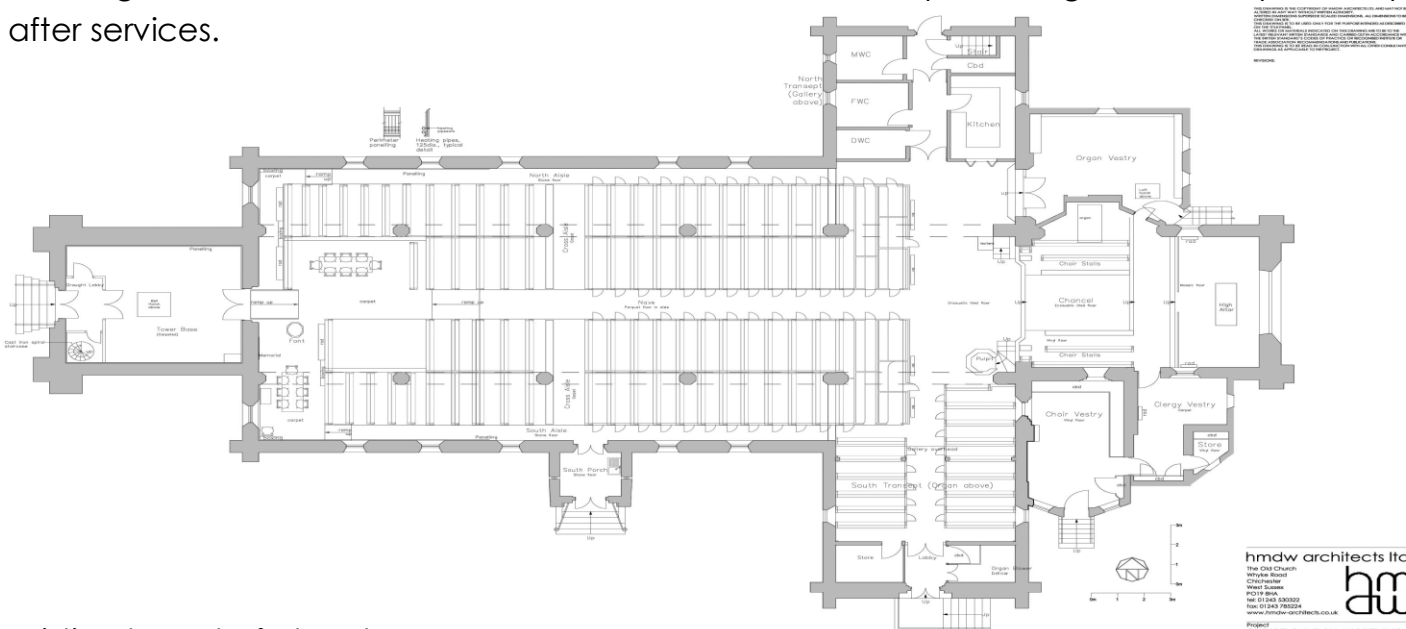

Existing layout of church

The next stage in our plans is to:

- Remove the remaining 6 pews at the side of the back of the church, thus creating a full hall space.
- Recreate a West Gallery [removed at the turn of the last century], to create a ceiling for a hall space.
- Install fully folding glass and oak doors, to be able to close off the 'Hall' space from the church worship space,
- Install underfloor heating, a serving area for refreshments, and a new oak floor to the hall space.
- Move the font, from the West end, to in front of the lectern, at the new disabled entrance in the north transept.
- Introduce a new staircase from the interior porch area, leading to a reading room in the first floor of the tower.

[This will be used for groups, such as the Rainbow Poetry group, for prayer and bible study groups and for the town councillor's surgery, who also meets with residents regularly each month in the church. The large collection of books ready to line the shelves can be available for schools and poetry enthusiasts.]

The Fabric Committee are working with the architect on the faculty and related work to move forward with this.



Proposed 'hall space', looking into the church through folding glass and oak doors.



Proposed 'Gallery at West end, looking at the sliding glass and oak doors, with gallery above

Holy Trinity: The PCC made the decision to close Holy Trinity many years ago, and at Easter 2014, our two congregations merged to form one worshipping family at Christ Church. Currently, the Diocese and the PCC are in talks with a Christian Church of another denomination, who are interested in leasing the church from the Diocese, on a long-term basis, and buying the Hall and Flat, adjacent to the church on the Holy Trinity site, and built on in the 1960s and can be easily separated from the main church building. These are owned by the PCC, held in trust for now by the Diocesan Board of Finance. It is hoped, if these talks go well, that any monies raised from the sale of the Hall and Flat would be used to convert the rear [West end] of Christ Church as a hall space.

Outreach, Community and Fellowship

Worthing appears at first sight prosperous, but according to the 2007 Index of multiple deprivation, Central Ward along with part of Heene Ward, where the Parish boundaries lie, are the most deprived areas in the town, and within the top 20% most deprived Wards in the country. The need, therefore, for the church to continue to establish itself as part of the community is an ongoing challenge.

Christ Church has an active outreach committee that meets monthly, with ongoing plans for even more activity in the future months and years. The church hosts six high quality musical concerts and six talks of general interest, mid-day on a Tuesday from September through to May.

The church is open for refreshments and fellowship three mornings and one afternoon each week, and alternate Saturday mornings. On Wednesday mornings, we raise funds for Mission, and every Thursday, there is a 'Knit and Natter' group that meets alongside the open church meetings. The 'Rainbow Poetry group' meets once a month on a Thursday afternoon, and a local town councillor holds surgeries once a month, also on a Thursday afternoon.

We have a fine grand piano, often used for concerts, social events and some worship songs on a Sunday morning, alongside hymns accompanied by the organ. The annual Christmas tree festival at Christ Church attracts many visitors, several who subsequently join us for our annual Carols by Candlelight at Christmas, which is very popular and well attended.

Youth

The church, with its box pews, is not ideal for children's worship. However, the organ vestry, at the East end of the church is decorated and furnished for a regular Sunday school, and there are several members of the parish able and fully DBS checked to lead children's church, should they be needed. Once the reordering of the west end is

complete, this will provide an ideal self-contained space, with under floor heating and audio-visual equipment for the possibility of fresh expressions type worship for children.

In 2014, the parish paid for a Youth Worker to try and increase activity with families and children in the Parish. She linked with Family Support Work, and we also paid for a case worker one day a week to work with the Youth Worker, supplying the use of the hall free of charge, providing activities for families and children in the area. The position of the hall in the town does not attract enough people to make this viable, and when the Youth Worker was called home to the US, the arrangement unfortunately ended as it had not borne any fruit.

There is a good relationship with the pre-school nursery across the road, and each year they have their 'graduation' service in the church, as well as their Christmas carol service, and they take part in the annual Christmas Tree festival. They have, in the past, also allowed the church to use their facilities at weekends as required, when the church held a community play, and when the previous vicar was installed, when church members used the nursery for changing.

Mission

The Parish has a long-standing commitment to Mission, both home and abroad, with personal links to:

Mission to Seafarers; Worthing Churches Homeless Projects; Family Support Work; CMS; CPAS; Bible Society, Mother's Union and Hope Now. The church invites three missions a year to come and talk at a Morning Prayer service, and join us afterwards to chat with the congregation over coffee. At these services, we have an additional collection towards their funds.

As a town centre church, many of our regular visitors drop into Christ Church for company, for advice and very often just for a listening ear. Many have now joined us and some are yet to join us, in worship. Sometimes, homeless folk meet in the church yard, where members of the congregation will chat and offer a hot drink.

We see this as vital work for God, "*Whenever you do this for the least of your brothers, you do this for me*".

To quote a poem by William J Crockett:

If this is not a place where tears are understood, where do I go to cry?

If this is not a place where my spirit can take wing, where do I go to fly?

If this is not a place where my questions can be asked, where do I go to seek?

If this is not a place where my feelings can be heard, where do I go to speak?

If this is not a place where you will accept me as I am, where can I go to be?

If this is not a place where I can try to learn and grow, where do I just be me?

The Parish Team & Pastoral Care

We are fortunate to have three retired members of clergy within our congregation, as well as many local retired ministers, who regularly help out with services.

The parish has a pastoral team who visit the sick and housebound, though we do need to recruit more members to this team. There are five trained lay ministers of communion.

Deanery and Diocese

The Parish has 96 members on the electoral roll. The Parish has 2 members of the laity on the Deanery Synod, including the deanery lay chair who is on Diocesan synod, and the parish is keen to work with other churches in the vicinity. Indeed, we frequently join St Andrew's Clifton Road for social events and occasionally we attend significant worship events together. The two churches are 'clustered' as a suggestion from the Deanery Pastoral Review 2014, from which we have both benefited. *A further review has been commissioned by the Bishop for the 4 churches currently in vacancy in the centre of the town. This identifies Christ Church as being of a different churchmanship to its neighbour churches, and for this reason, special consideration should be given to any incoming minister, so that he or she is aware of the needs of the congregation worshipping here.*

The Vicarage

The Vicarage at 5, Christchurch Road Worthing, BN11 1JH is situated on the south corner of Abbotts Close and Christchurch Road, opposite to the Civic Centre car park within several yards of Christ Church, and has recently been refurbished and expanded to meet Incumbent status.



Financial state

The Parochial Church Council [PCC] met their commitment of 100% of the Parish Ministry Cost [PMC] for 2015. For 2016, the PCC decided that the parish cannot afford to pay this

cost as well as maintain the Holy Trinity building at a cost of approximately £10,000 per annum. The PCC offered to pay 86.75%, with an explanation to the Deanery Treasurer the reasons for not committing the Parish to 100%.

The parish ran a 'TRIO' stewardship campaign in early 2016 but the effort saw minimal results.

In 2017 the PCC decided to further reduce their PMC during this interregnum to 58.50%. Their reasons for a further reduction was the loss of planned givers directly following the leaving of the Minister, coupled with the continuing expenditure on the Holy Trinity site and the mindful consideration we should have for our charitable status and the public benefit.

Voluntary receipts have started to increase as numbers of attendees grow. Members of the congregation are increasingly paying through the Parish Giving Scheme [PGS], with Gift Aid, with the others giving in general through the use of the Parish Gift Aid envelopes. It is encouraging to note that the PCC is claiming the maximum amount of gift aid allowed for by the Government. The level of voluntary and other income from the congregation is currently not sufficient to cover normal revenue expenditure including the Parish Ministry Costs. However, according to the last diocesan reports, the parish had the highest amount of giving per person per week in the deanery [£13 per person per week.]. There remains a continuing need to explore all means of increasing income from the present church membership while at the same time, encouraging more people to join us.

Parish Support and resources

The parish has a full time unpaid administrator who deals with all aspects of the smooth running of the parish. Although she works from home, there is an office within the church where we have computer access and an advanced photocopier that produces service booklets each week. There are several members of the parish who assist with the administration, day to day copying etc.

The Christ Church website, administered by members, has recently been relaunched, and has been very well received as being informative and helpful. The website publishes the pews sheet each Thursday, ahead of the Sunday Services, for those who are unable to attend. We have many 'Friends' of the church who have asked to be kept informed of all events that happen, and regular emails are sent out with posters and relevant information about the church and what is going on. The Church produces a monthly magazine, which is delivered to the surrounding community. This is also published on the website.

We have great ideas for the future. The challenge is to grow in number to ensure there are many to carry the happy load.

In Summary:

The parish are seeking an experienced priest with a clear grasp of the theology of Christ Church, that needs to be understood, so as not to repeat the problems of the past. We are of a traditional persuasion, serving a particular profile of people in the surrounding community. He or she needs to be open minded, and prepared to work with us, rather than for us, over friendly rather than too reserved and be blessed with a sense of humour!

We sincerely hope and pray that is you!

Current Officers of Parish:

Church Wardens:	Kenneth Hobbs & Simon Davies	
Parish Treasurer:	Kenneth Hobbs	
PCC Secretary:	Janine Hobbs	
PCC Minute Secretary:	Jenny Stead	
Administrator:	Janine Hobbs	
Verger:	Lorraine Roberts	
PCC members:	Ralph Waters Jenny Chandler Dr. Chris Clarke Lorraine Roberts	Dorothy Foan Miles Young John Collins Helene Vine

Deanery Synod Reps: Dr John Bull & Janine Hobbs [Diocesan Synod & Deanery Lay Chair]

